



BUILDING PROFILE

33,927 SF on 24 Acres

City: Dadeville

County: Tallapoosa

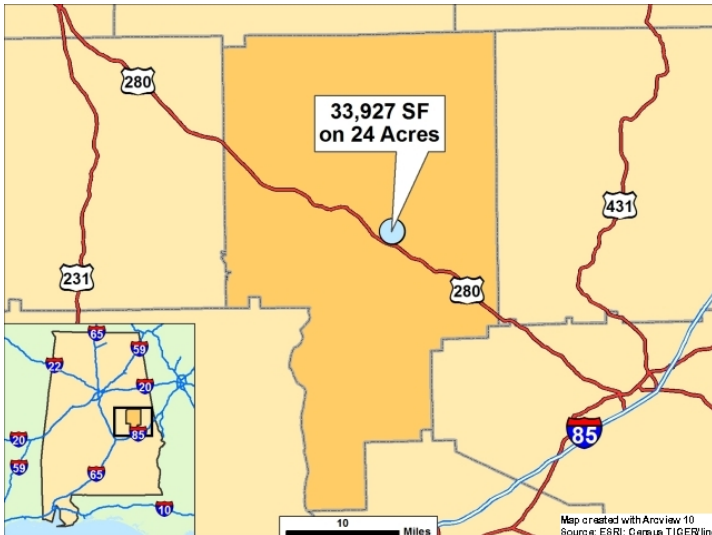

General Building Data

Street Address: 176 Main Street
Nearest City: Dadeville
Within City Limits: Yes
Zip Code: 36853
MSA:
Latitude: 32.83927500
Longitude: -85.75960000
Loc. In Industrial Park: No
Park Name:
Within Enterprise Zone:
Within Favored Geo Area:
Within Renewal Community:
Within HubZone:
Within New Market Tax Credit Area:

Total Size: 33,927 Sq. Ft.
Space Available: 33,927 Sq. Ft.
Multi-tenant:
Number of Buildings: 1
Number of Floors: 1
Building Dimensions:
Largest Production Area: 32567.00
Building Expandable:
Expandable To:
Total Acreage: 24.00
Additional Available:
Ceiling Height: Eave: 16 ft
 Max: 18 ft

Transportation

Rail Service

Provider: Norfolk Southern
Track Status: <1 Mile
Provider 2: Norfolk Southern
Track Status: <1 Mile

Waterway

Provider:
Dock Facility: Not Specified

Nearest Commercial Air City

Montgomery, AL
 Mi. to Service: 65

Nearest Municipal Air City

Birmingham
 Mi. to Service: 85

Highways

Type	Name	Mi. To Access	4 Lane?
------	------	---------------	---------

Floor Thickness:

Bay Spacing: Length:

Air Conditioned:

Heated: Yes
Cranes: Number:
 Cap Lrgst: ton(s)
 Under Hook:

Truck Docks:

Year Built: 1984
Last Expansion:
Refrigerated Area:
USDA Approved:
Sprinklers:
Construction Material: Primary: Masonry
 Secondary:

Parking Paved:

Number of cars:
Zoning: Light Industry
Office Area: 1,306 Sq. Ft.
Previous Use:
Previous Use Desc:



www.edpa.org

BUILDING PROFILE

Utilities

Natural Gas

Provider: City of Dadeville
 Status: Not Specified
 Size of Main:
 Main PSI:

Electric

Provider: Alabama Power Company
 Status: Not Specified
 Amps:
 Phase:
 Voltage:

Water

Provider: City of Dadeville
 Status: Not Specified
 Size of Main:

Fiber/Telecom

Provider:
 Fiber Optics:
 Redundancy:
 xDSL Available:

Sewer

Provider: City of Dadeville
 Status: Not Specified
 Size of Main:

Price

Base Rent (Annual):
Sale Price: \$400,000.00

Negotiable:
Date Quoted: 7/5/2017 10:28:44 AM
Price Comments:

Key Building Features

Great warehouse space. A former textile mill plant and accessory building comprising of roughly 83,449 sf are a part of property.

Building Comments



Economic Development
Partnership of Alabama

www.edpa.org

BUILDING PROFILE

